

# HERCULES REGURUS ALTAIR

**HERCULES**  
[TAV2812DCIR-MP]

3 Mega



**REGURUS**  
[HD338DCIR]

1.3 Mega



**ALTAIR**  
[HD880MIR]

1.5 Mega



**ALTAIR**  
[HV880DCIR-MP]

1.5 Mega



## SPECIFICATIONS

Part NO.	Image Size	Mount	Focal Length f =	Iris Range	Angle of View	M.O.D.	Operation			F.B.	Filter Size	Size (mm)	Weight
							Focus	Zoom	Iris				
TAV2812DCIR-MP	1/3"	CS	2.8-12mm	F1.4-360	97.9×72.5°~25.0×18.8°	0.3m	Manual	DC	12.5mm	—	φ41.3×59.4	—	
HD338DCIR	1/3"	CS	3.3-8mm	F1.4-360	87.9×64.5°~35.0×26.2°	0.5m	Manual	DC	12.5mm	—	φ44.2×53.5×52.8	45g	
HD880MIR	1/2"	C	8-80mm	F1.6-Close	46.6×34.3°~4.7×3.6°	0.1~0.7m	Manual			17.526mm	52mm	φ58×91.5	400g
HV880DCIR-MP	1/2"	C	8-80mm	F1.6-360	46.6×34.3°~4.7×3.6°	0.1~0.7m	Manual	DC	17.526mm	52mm	φ54×91.0	198g	

## DIMENSIONS

**HERCULES**  
[TAV2812DCIR-MP]

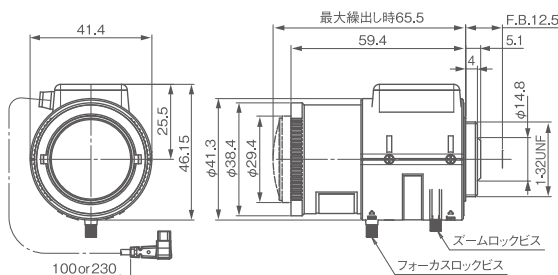

**REGURUS**  
[HD338DCIR]

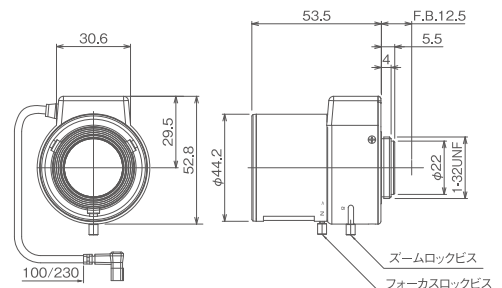

**ALTAIR**  
[HD880MIR]

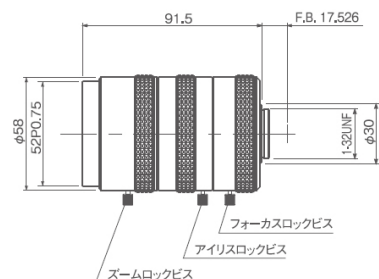

**ALTAIR**  
[HV880DCIR-MP]

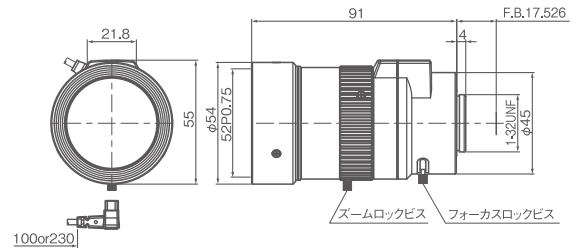

(單位 : mm)

## CIRCUIT DIAGRAM

HERCULES [TAV2812DCIR-MP] / REGURUS [HD338DCIR] / ALTAIR [HV880DCIR-MP]

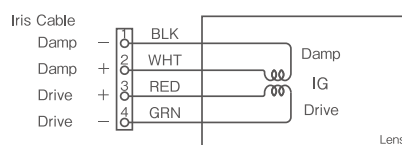

規格與外觀若有變更, 恕不另行通知。